

DRAWING NAME AND LOCATION: P:\Projects\Crown Property\CPM-116-90 Sheppard E-103\Plans\Feasibility\fe02-90Sheppard-101-cpm116-22apr19.dwg

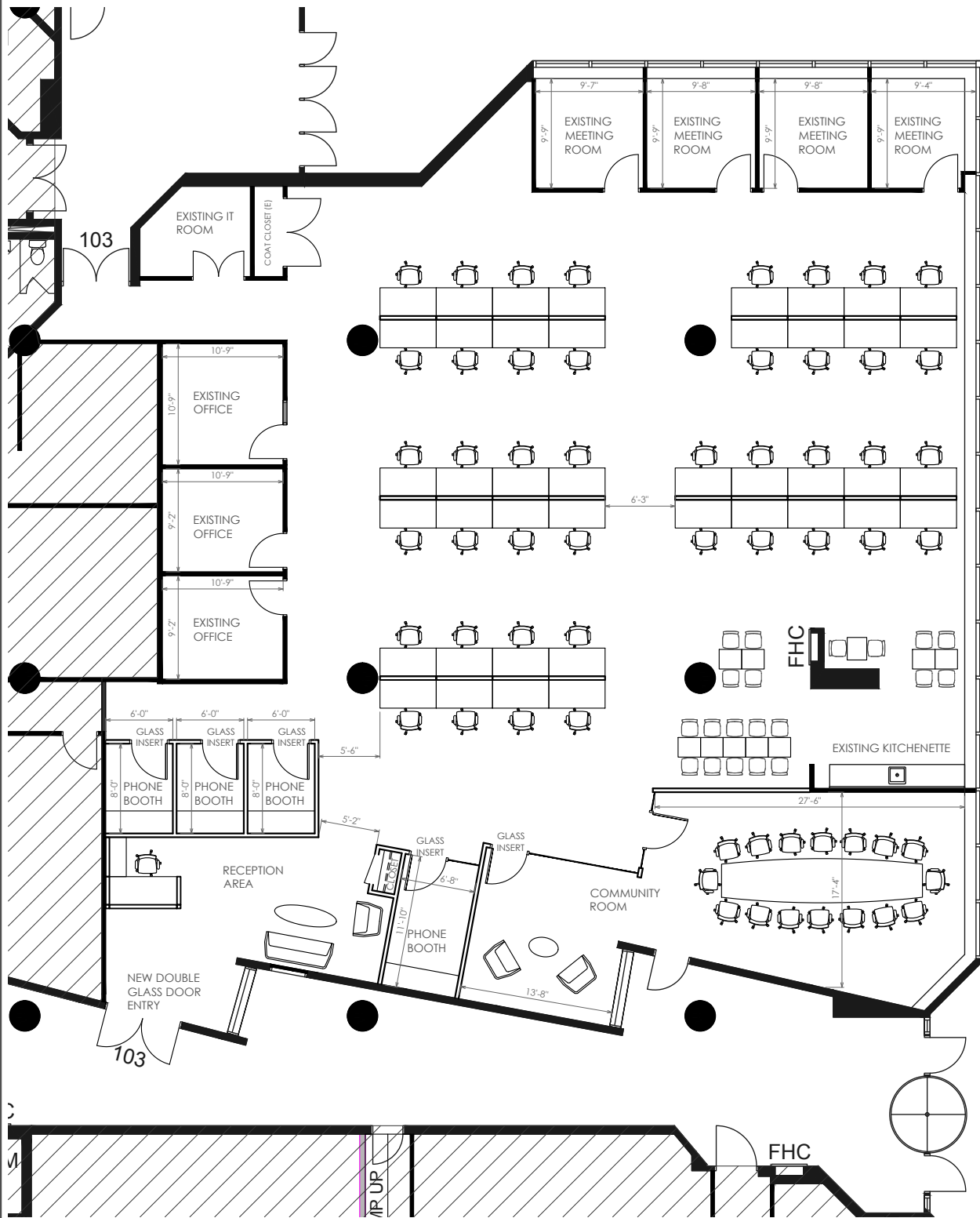

5'-0"

2'-6"

WORKSTATION: 30"X60"

TOTAL: 42

OFFICES: 3

MEETING ROOMS: 4

PHONE BOOTHS: 4

COMMUNITY ROOM: 1

KITCHENETTE: 1

CROWN

PROPERTY MANAGEMENT

90 Sheppard E, #101
Toronto, Ontario

prepared by **bluedot studio limited** 416-241-9600

Newmark Knight Frank
Feasibility Plan

fe-02

REVISED: 22apr19

PROJECT#: cpm-116

This feasibility plan is based on the demising wall layout provided by the Client. The premises have not been verified by bluedot studio for accuracy. E&OE.