

KEY PLAN

MEETING ROOM

--- DEMISING WALL UNDER CONSTRUCTION
 — DEMISING WALL

0 5 25 FT.

SUITE 503
RENTABLE AREA = 5,749 SF

ABOVE INFORMATION ESTABLISHED ACCORDING
 TO ANSI / BOMA Z65.1 1996

February 7, 2023

© 2023 Space Database Inc. All Rights Reserved



901 King Street West
 Toronto, ON
 Suite 503

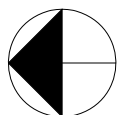

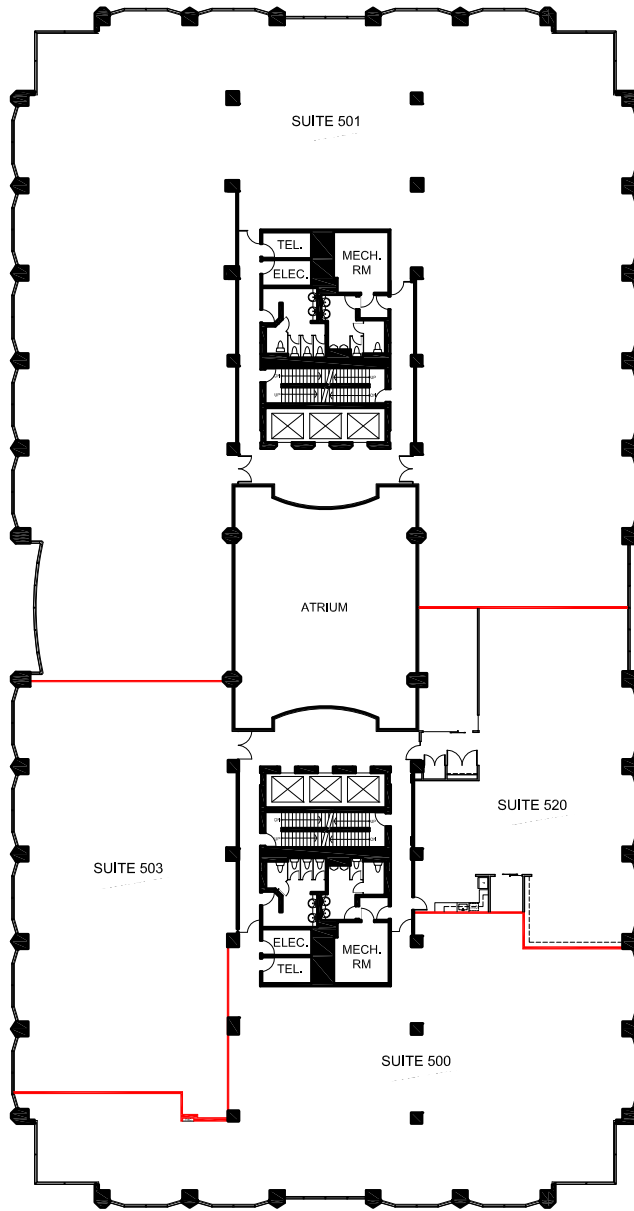

— DEMISING WALL

0 10 50 FT.

AREA SUMMARY

SUITE No.	USABLE AREA	RENTABLE AREA
500	6,339 S.F.	7,539 S.F.
501	16,345 S.F.	19,438 S.F.
503	4,812 S.F.	5,723 S.F.
520	3,737 S.F.	4,444 S.F.
TOTAL	31,234 S.F.	37,144 S.F.

R/U RATIO = 1.189213
 ABOVE INFORMATION ESTABLISHED ACCORDING
 TO ANSI / BOMA Z65.1 1996



APPROXIMATE NORTH

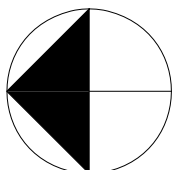

PROJECT NAME

901 KING STREET WEST
 TORONTO, ONTARIO

DRAWING NAME

FIFTH FLOOR
 AREA SUMMARY

SCALE
 AS NOTED

DATE
 JANUARY 26, 2023

DRAWING NO.
 R5