

KEY PLAN

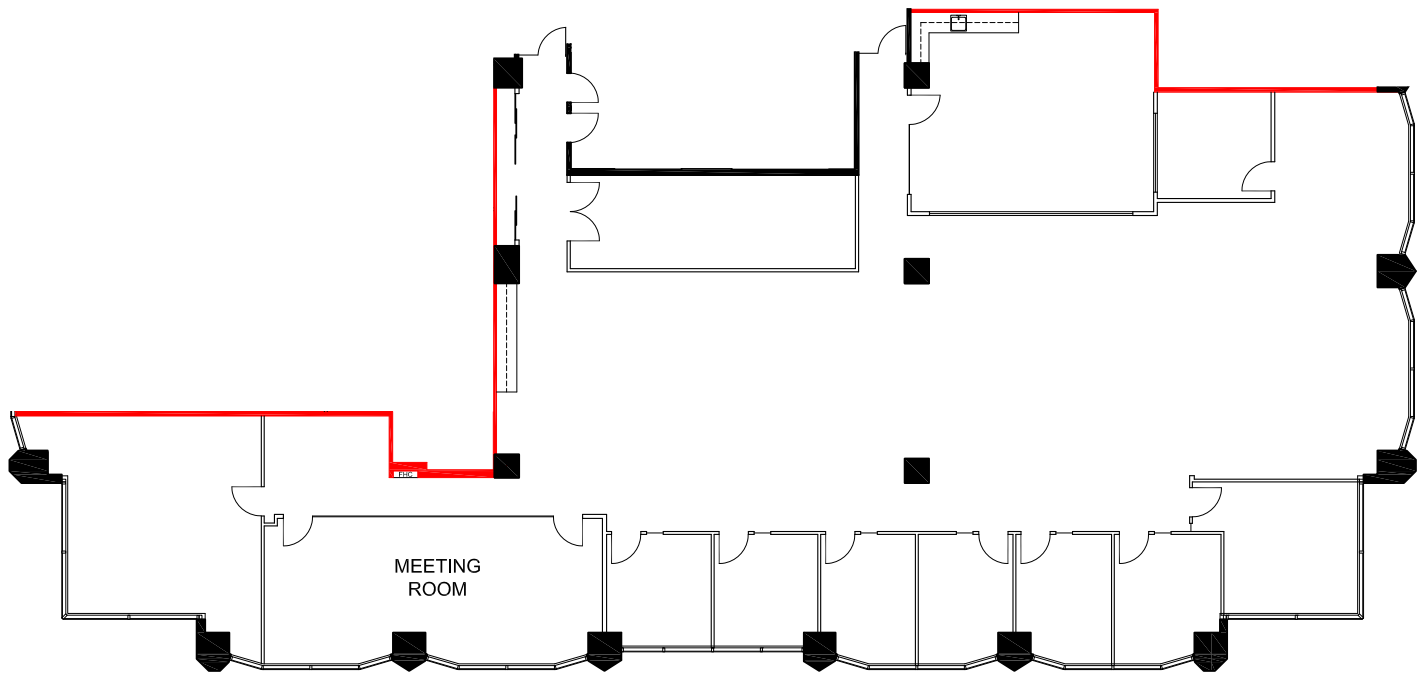

 DEMISING WALL



SUITE 500

RENTABLE AREA = 7,539 SF

ABOVE INFORMATION ESTABLISHED ACCORDING
TO BOMA / ANSI Z65.1 1996



901 King Street West
Toronto, ON
Suite 500

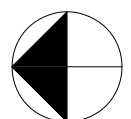

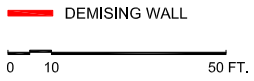
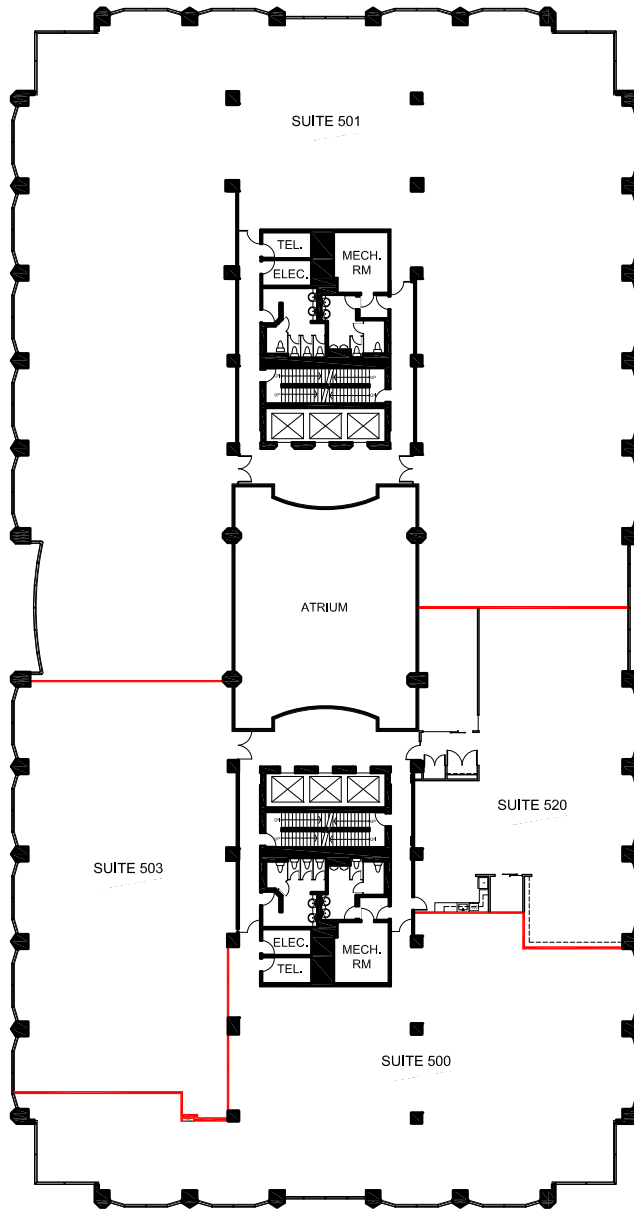

AREA SUMMARY

SUITE No.	USABLE AREA	RENTABLE AREA
500	6,339 S.F.	7,539 S.F.
501	16,345 S.F.	19,438 S.F.
503	4,812 S.F.	5,723 S.F.
520	3,737 S.F.	4,444 S.F.
TOTAL	31,234 S.F.	37,144 S.F.

R/U RATIO = 1.189213
 ABOVE INFORMATION ESTABLISHED ACCORDING TO ANSI / BOMA Z65.1 1996

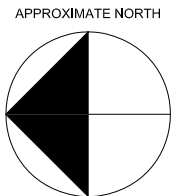

PROJECT NAME
**901 KING STREET WEST
 TORONTO, ONTARIO**

DRAWING NAME
**FIFTH FLOOR
 AREA SUMMARY**

SCALE
 AS NOTED

DATE
 JANUARY 26, 2023

DRAWING NO.
R5