

# west

901 KING ST W

## Floor Plans

**Suite** 500  
**Size** 7,556 sq. ft.  
**Available** Immediately

**Comments** Fantastic opportunity with exposed ceiling and unique design features. Efficient layout with mix of offices, boardrooms, meeting rooms and private offices. Furniture can be made available.

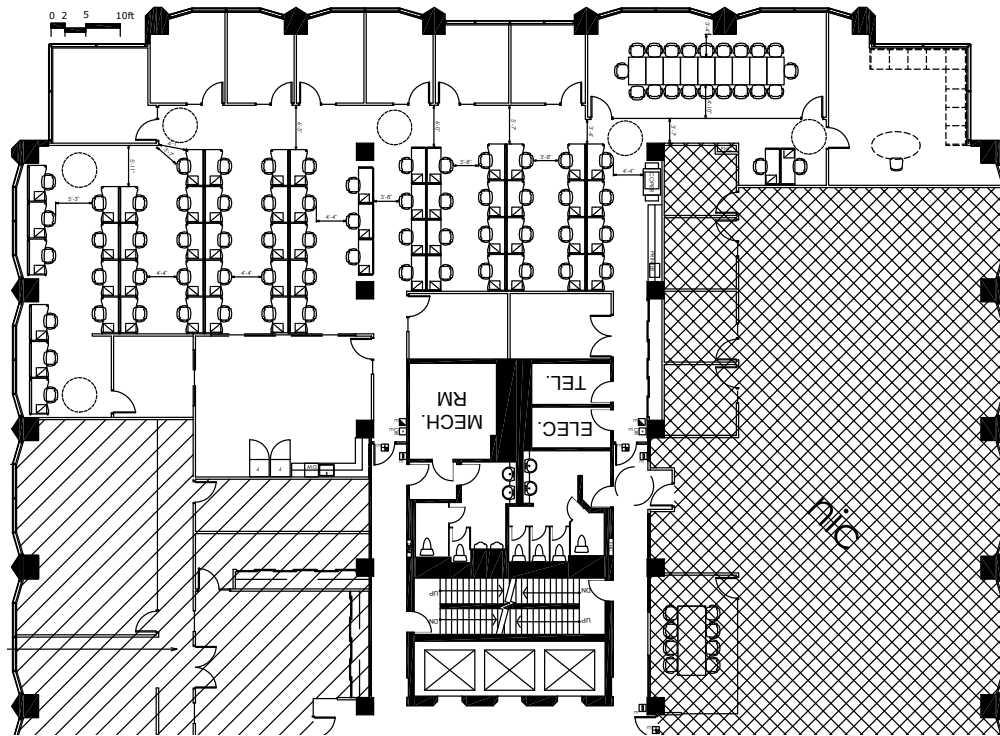

FULLY  
FURNISHED  
SUITE

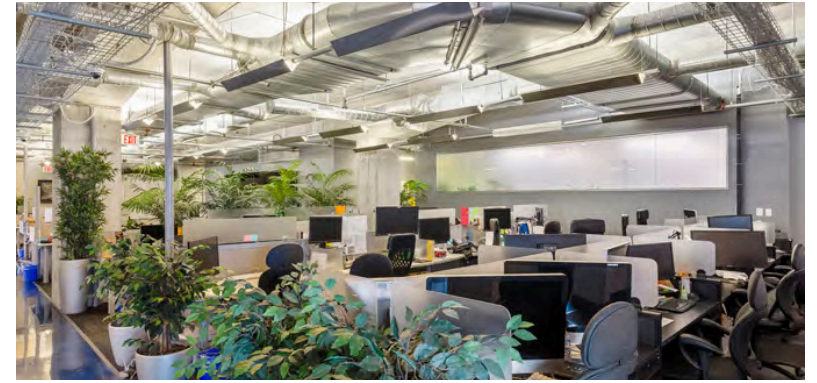

## Get In Touch!

**Brendan Sullivan\***  
Senior Vice President  
+1 (416) 576 3335  
brendan.sullivan@cbre.com

**Michael Spence\***  
Vice President  
+1 (416) 815 2379  
michael.spence@cbre.com

**Myah Ollek**  
Sales Representative  
+1 (416) 815 2353  
myah.ollek@cbre.com

**CBRE**

**CROWN**  
REALTY PARTNERS

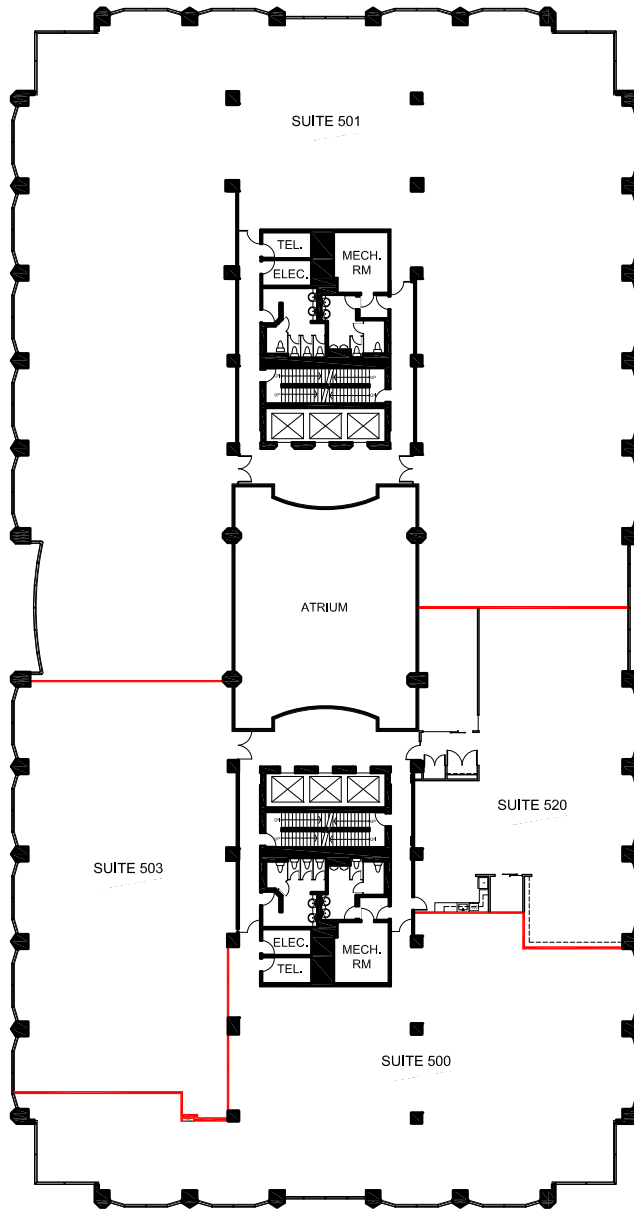

— DEMISING WALL

0 10 50 FT.

**AREA SUMMARY**

SUITE No.	USABLE AREA	RENTABLE AREA
500	6,339 S.F.	7,539 S.F.
501	16,345 S.F.	19,438 S.F.
503	4,812 S.F.	5,723 S.F.
520	3,737 S.F.	4,444 S.F.
<b>TOTAL</b>	<b>31,234 S.F.</b>	<b>37,144 S.F.</b>

R/U RATIO = 1.189213  
 ABOVE INFORMATION ESTABLISHED ACCORDING  
 TO ANSI / BOMA Z65.1 1996



APPROXIMATE NORTH

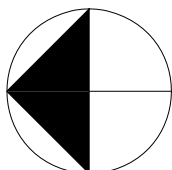

PROJECT NAME

**901 KING STREET WEST  
 TORONTO, ONTARIO**

DRAWING NAME

**FIFTH FLOOR  
 AREA SUMMARY**

SCALE  
 AS NOTED

DATE  
 JANUARY 26, 2023

DRAWING NO.  
**R5**