

# west

901 KING ST W

## Floor Plans

**Suite** 200/201  
**Size** 20,409 sq. ft.  
**Available** Immediately

**Comments** Dual off-elevator exposure. Efficient layout with mix of private offices, meeting rooms, and expansive open areas for cubicles and/or collaborative work spaces. Furniture can be made available.

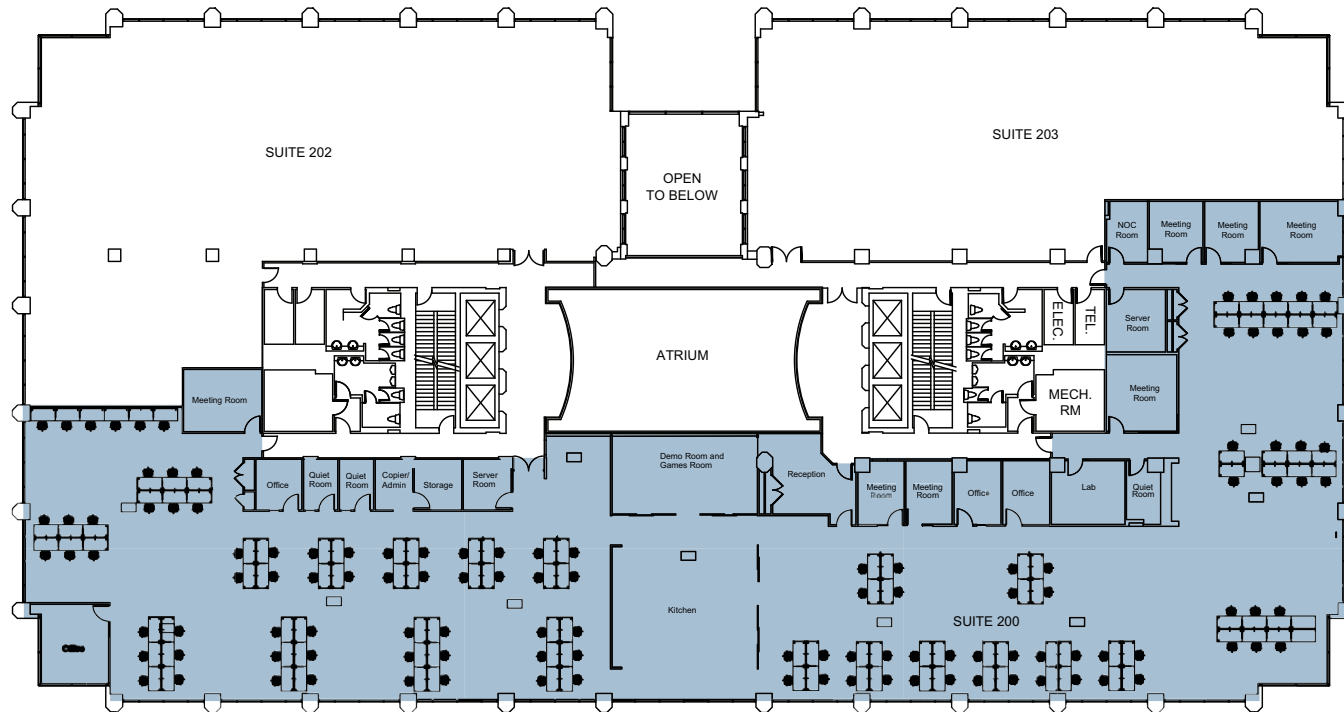

FULLY  
FURNISHED  
SUITE

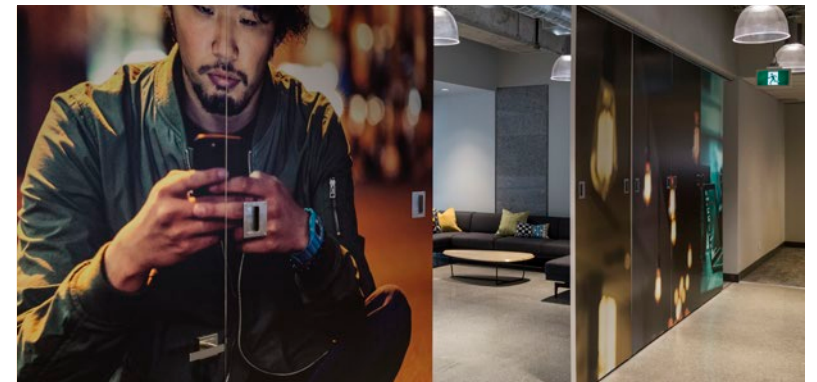

## Get In Touch!

**Christina Karam\*** | Director, Leasing | 416.572.3000 | ckaram@crp-cpmi.com

